

SLJM-10 油壓起道機

- 可獨立操作，高機動性。
- 低爪位。
- 最少施力，方便操作。
- 鋁合金本體，重量輕。

Lifting Jacks

- ※Self-contained models for maximum versatility.
- ※Low toe heights fit in tight clearances.
- ※The lowest handle effort for easy operation.
- ※Alluminum body, the lowest weight for reduced back injuries.



適用性 Application

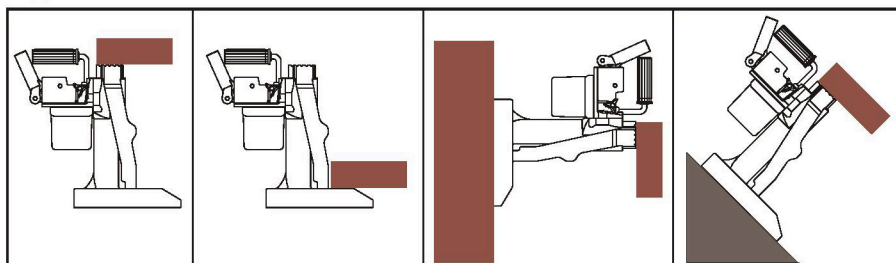

SLJM10-A04 強力爪塊 Strong Toe-Lift

優點：一體成型鑄造，耐荷重，不易變形、斷裂。
Advantage: Casting integral, heavy duty, not easily deformed and fracture.

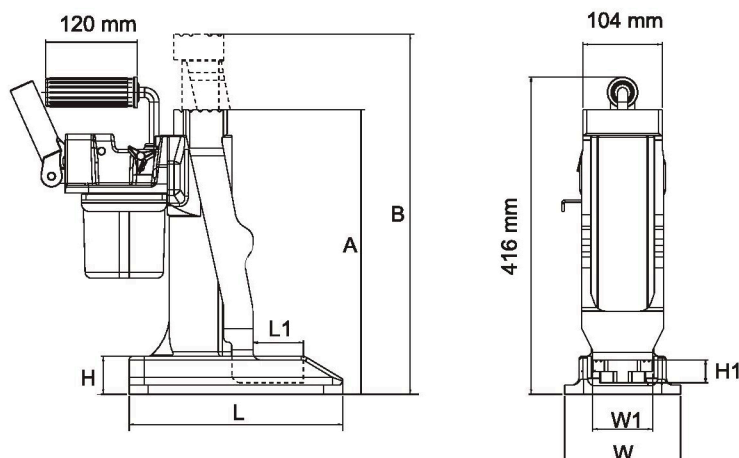

型號 Model No.	頂部荷重 Top cap. (ton)	爪部荷重 Low toe-Lift cap. (ton)	揚程 Stroke (mm)	本身高 Min. Height A (mm)	伸長總高 Ext. Height B (mm)	底座尺寸 Base Dimensions L x W x H (mm)	頂爪尺寸 Top Toe-Lift Dimensions L1 x W1 x H1 (mm)	總重 Weight (kg)	使用壓力 working press Rang (bar)
SLJM-10	10.0	8.5	225	373	598	280 x 152 x 50	66 x 79 x 30	19.5	560